

ROHS COMPLIANT

REVISIONS		
REV.	DESCRIPTION	DATE

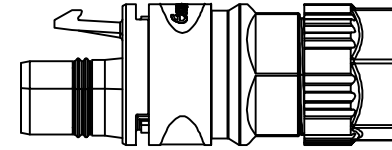
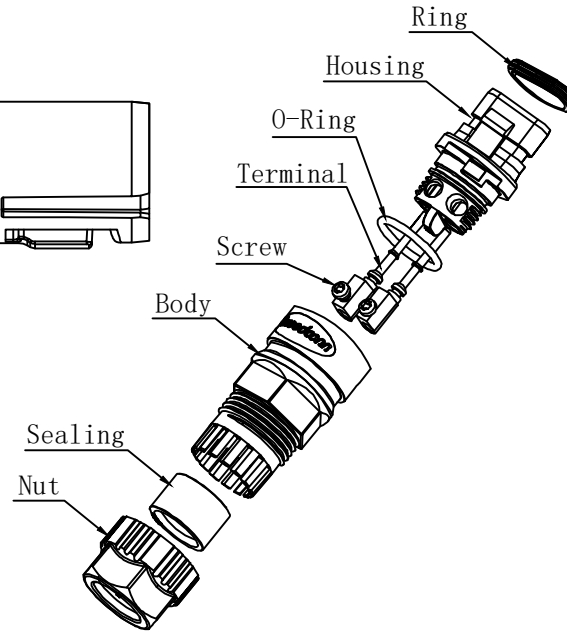
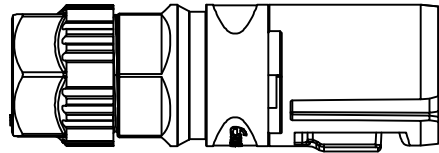
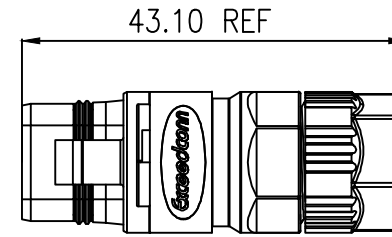
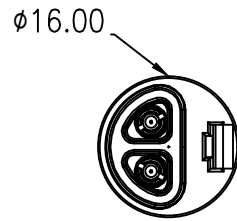
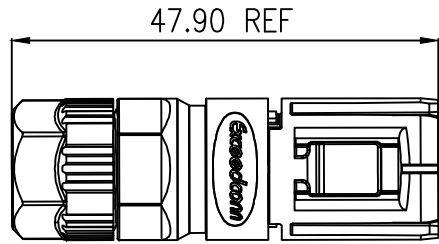

Technical Data :

Electrical:

1. Rated Voltage : UL 300V;
CQC/TUV 450V;
2. Rated Current : 10A
3. Rated Impulse Voltage: 2500V
4. Contact Resistance : $\leq 10\text{m}\Omega$;
5. Insulation Resistance : $\geq 500\text{M}\Omega$

Mechanical:

1. Life cycle : 50 cycle;
2. Mating Force: $\leq 25\text{N}$;
3. Cable Retention Force: OD:5.4-9mm, $F \geq 80\text{N}$;
4. Cable Gauge: $0.5 \sim 2.0\text{mm}^2$;

Environmental:

1. Waterproof Rate : IP68
2. Application Temperature : $-40^\circ\text{C} \sim +85^\circ\text{C}$

NO.	DESCRIPTION	SPEC
①		1
②		1
③		1
④		
⑤		100 to 200 ± 10
⑥		200 up $\pm 2.0\%$

SHENZHEN LEDE ELECTRONIC CO., LTD

Website: www.LEDcable.com Email:sales@LEDcable.com 电话 TEL: 0755-23033626

Toerance: up to 5mm ± 2 5 to 100 ± 5 100 to 200 ± 10 200 up $\pm 2.0\%$	产品名称 Product Name	编号 Item No	批准 Approve	角法 Projection	ϕ \square
	版本号 Edition	材料 Material	审核 Audit	单位 Unit	mm
	日期 Date	制作 Author	LBC	比例 Scale	